

GAIM

A step-by-step guide
to get you started with
GAIM Hunting and Sport Shooting.

English

GAIM

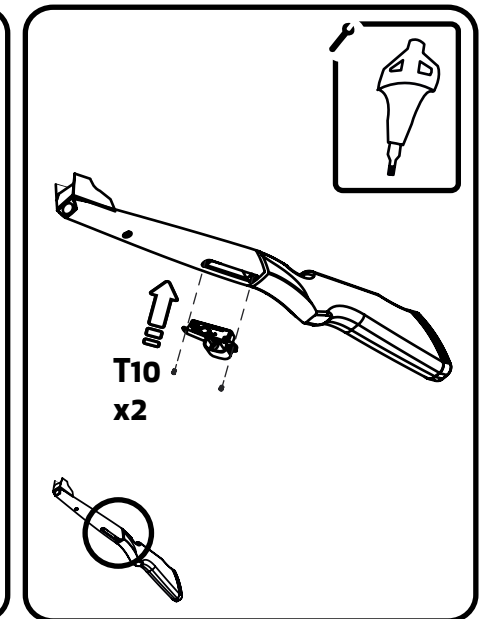
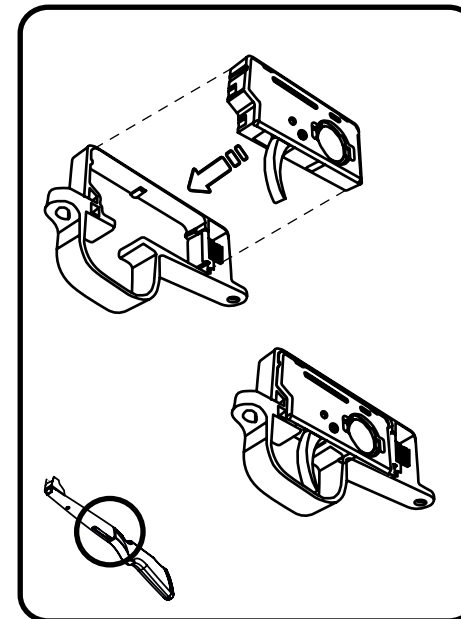
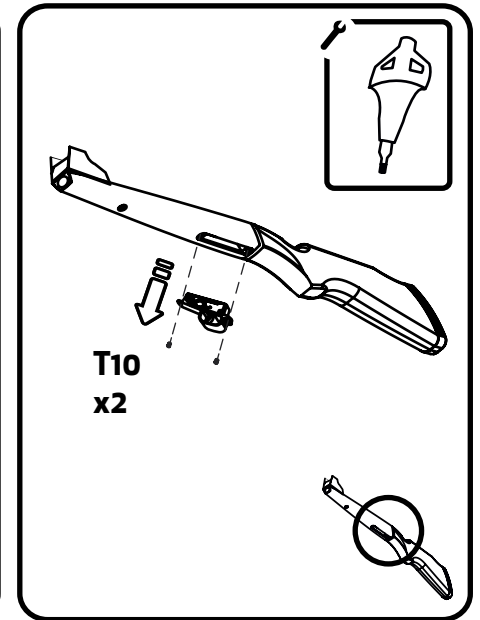
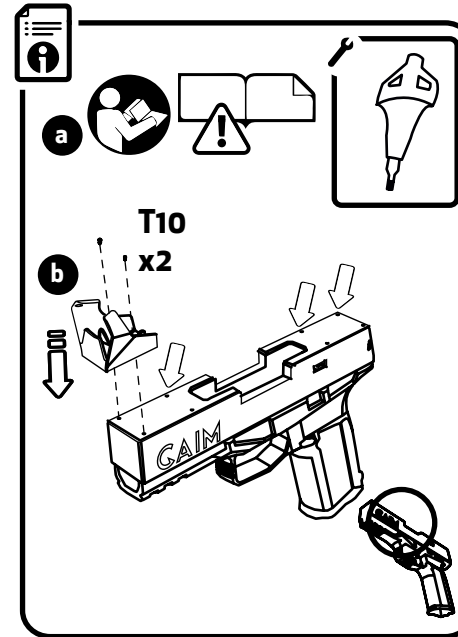
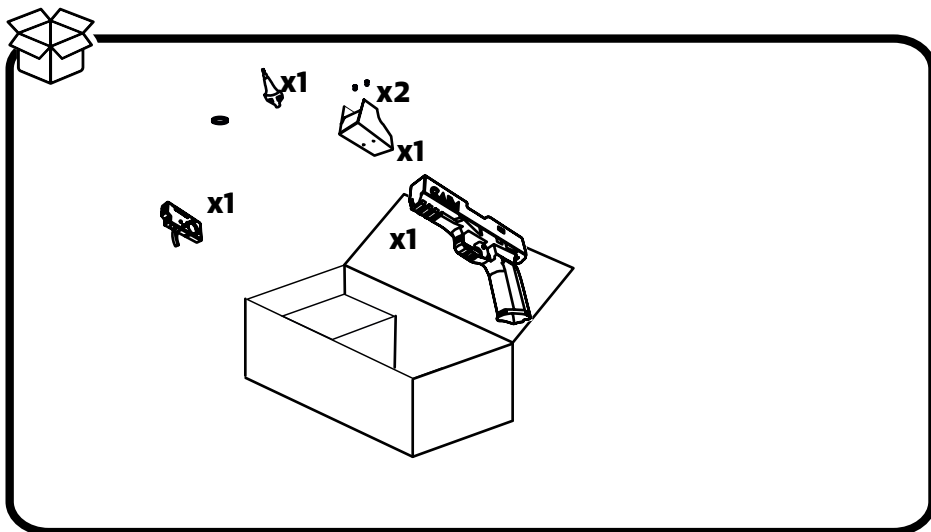
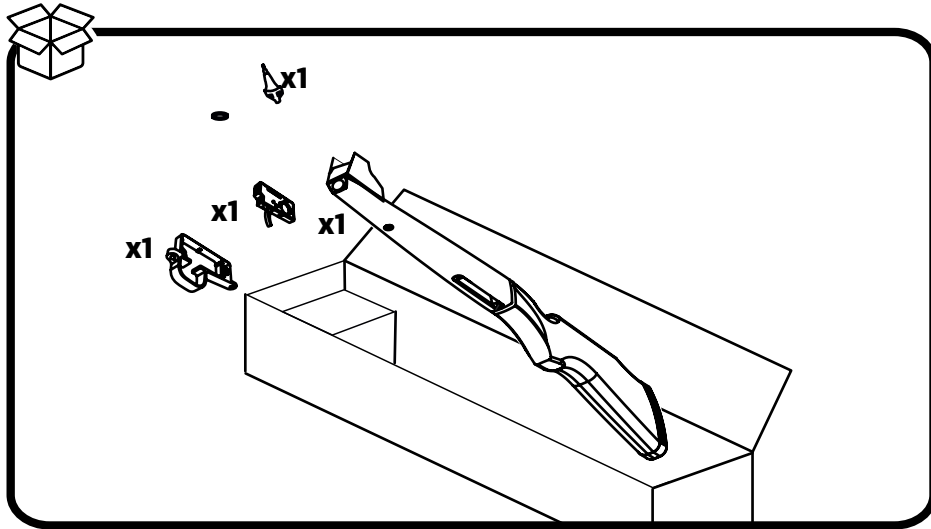

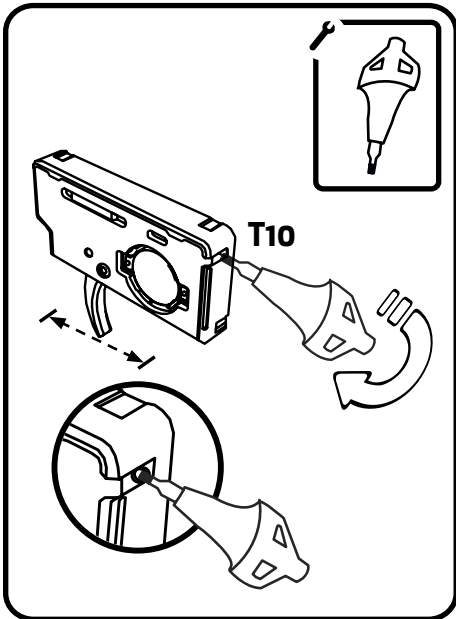
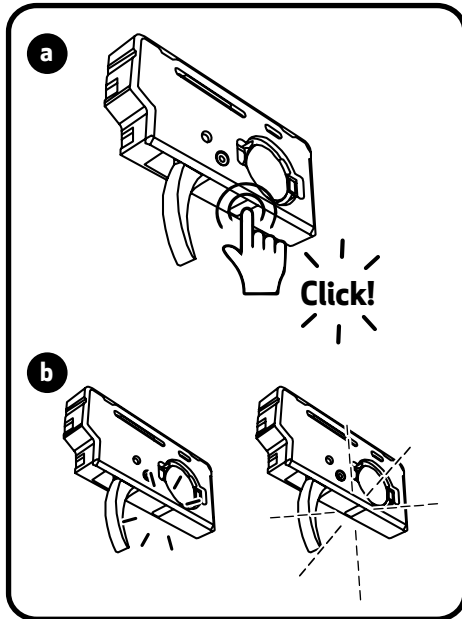
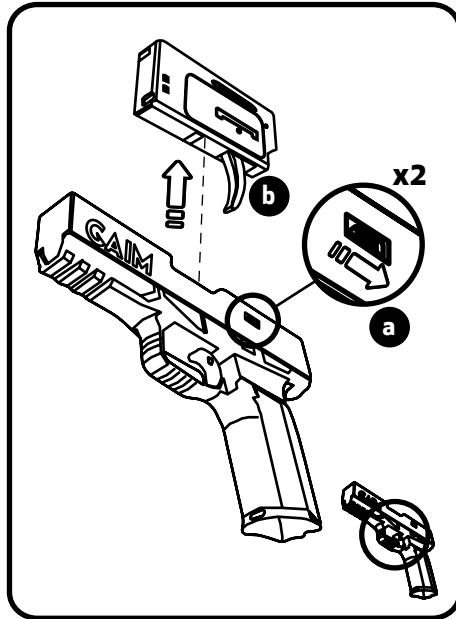
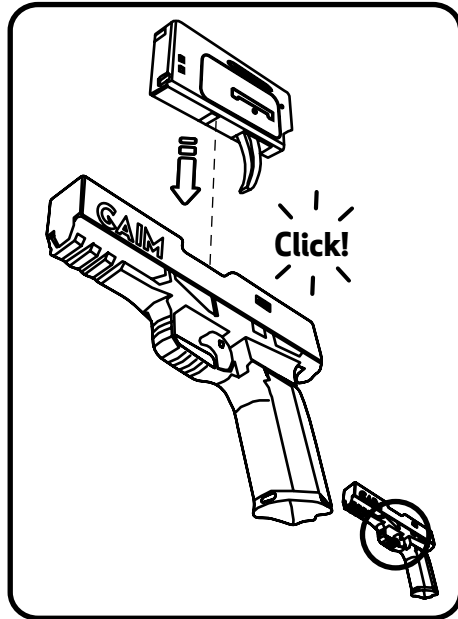

Set up a Meta account and connect your headset

1. Download the Meta Quest app on your phone.
2. Follow the instructions in the app to create a Meta account.
3. Connect your headset to the Meta Quest app.

In the Meta Quest app on your phone go to: Devices // Pair New Headset // select Quest 2 // follow the instructions in the app and headset

Download the GAIM app

1. Open the camera on your phone and hold it over the QR code to the right to be sent to the download page, or visit the website at bit.ly/downloadgaim.
2. Press "Get" and the GAIM app will be added to your library in your headset. You will find the GAIM App after a few minutes under apps in your headset.
3. You can also search for GAIM in your Meta app on the phone. Click "Show app" under App Lab. Then click on GAIM to download.



Enter license key

1. Inside headset, start the GAIM App.
2. Enter your license key exactly as written in your confirmation e-mail (e.g. X1X5X-7XXX9-XX4X3).
3. Press "play".

Start using the system

When the license key is accepted, and the trigger is connected (see page 6) to the headset, the GAIM system is ready to be used.

1. Click on profile to enter and edit profiles. Get a profile for each player to save time on weapons adjustment, get personal high scores and shot counter.
2. Click on cog wheel to enter settings where you can adjust the weapon settings etc.
3. Click on any tile to open content.



Trigger Bluetooth pairing in the Meta headset

1. Put the battery in the trigger unit.
2. The LED button will blink several colors. Press the LED light button for 3 seconds until it blinks red for 1 second followed by a yellow blinking light. This means the trigger is reset and ready to pair again.
3. The LED light should blink yellow indicating that the trigger is actively searching for a connection.
4. In the headset go to Settings // Devices // Bluetooth pairing.
If the GAIM Controller is visible but listed as Previously Paired, you need to forget this device. Then exit the menu and enter it again.
5. Pair with the GAIM Controller
6. When connected the trigger will blink green at every shot.

Trigger Bluetooth pairing in the Meta app

1. Before you start pairing the GAIM controller, make sure that ...
 - the headset and your smartphone are connected to the same Wi-Fi
 - the headset is cleared from all previous Bluetooth connections.
2. Open the Meta Quest app on your phone. In the app, click on devices and select your headset. It should say "Connected" in the top left corner.
3. Put the battery in the trigger unit.
4. The LED button will blink several colors. Press the LED light button for 3 seconds until it blinks red for 1 second followed by a yellow blinking light. This means the trigger is reset and ready to pair again.
5. Click on Controllers.
6. Click on Pair New Controller.
7. Click on Pair Gamepad.
8. The LED light should blink yellow indicating that the trigger is actively searching for a connection. If it stops blinking yellow before a connection is made pull the trigger like a shot and it will start blinking again. (It may take a moment for it to appear in the list. If the app never stops searching, restart the app and try again.)
9. Select GAIM Controller from the list on your phone.
10. **You will receive a red error message that you can ignore. The trigger is connected!**
11. When connected the trigger will blink green at every shot.

Next time you use the headset:

- A. Start Meta Quest headset.
- B. Pull the trigger one or two times.
- C. Start the GAIM application.
- D. If the trigger is not active. Pull the trigger one or two times. Wait a few seconds for the Bluetooth to connect again. Try again.
- E. To reconnect with the trigger enter the headset Settings // Devices // Bluetooth pairing. Find GAIM Controller listed as previously paired. Reconnect to it.
- F. If this doesn't work. Forget the connection, reset the trigger by pressing the LED light button for 3 seconds. Then try to connect to GAIM Controller in the headset Bluetooth menu or via the Meta Quest app.

Recommended Meta Quest settings

Vibrations

You can lower the vibrations in the Meta Quest controller.

In the headset, go to:

Settings // Hands and Controllers // Controllers // Vibration Intensity and then put the intensity to high.

Inactivate Video Capture Indicator

When recording or casting from your headset, a red dot appears that can be removed. In the headset, go to:

Settings // System // Video // Video Capture Indicator and turn it off.

Cast video from the correct screen

When casting to an external screen, you should view the image from the right or left headset screen depending on which side you hold the weapon. Go to:

Settings // System // Video // Select Right eye or Left eye

Room Scale Boundary

We recommend using Room Scale Boundary to avoid the guardian to show when swinging the rifle.

Microphone should not be on mute Settings // Devices // Mute Microphone (Off)

Set sleep mode to 15 minutes:

Settings // System // Power // Auto Sleep Headset





WARNING! Prior to using your GAIM, please observe all safety warnings by Oculus regarding your Oculus Quest headset:
<https://www.oculus.com/legal/health-and-safety-warnings/>
 *Oculus Quest is now Meta Quest.



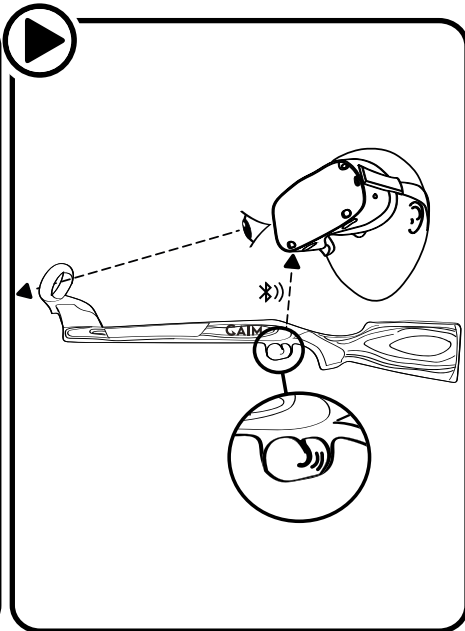

GAIM is responsible for weapon controller (wooden stock, trigger unit and controller holder) and software from GAIM OS for hunting and shooting practice.
GAIM is not responsible for the use of VR headset and accompanied hand controllers.

Please read the warnings below carefully before using the GAIM virtual reality system (the "Product") and follow all Product safety and operating instructions included in your GAIM kit to reduce the risk of personal injury, discomfort or property damage.

Use of this Product is at your own risk. GAIM Immersive Technology Group AB does not provide supervision, except as provided for under mandatory consumer protection and/or product liability legislation, and does not accept responsibility for any personal injuries, illness, death, loss, damage (to property or otherwise), expenses incurred or any other claim whatsoever that may arise from your use of this Product.

Proper Setup:

- Read and follow all setup and operating instructions that come with the Product components to ensure proper configuration prior to use.
- Do not disassemble or make any unauthorized alterations to the Product components.
- Do not attempt to utilize the Product for anything other than its intended application hunting and shooting training.

Use by Children:

- This product contains small parts which may be a choking hazard. Not suitable for children under age 3.
- Adults who permit children to use this Product should monitor them closely for any negative effects during and after their use and should also ensure that children avoid prolonged use of the Product. Do not allow the continued use of this Product if negative effects are observed.

General Precautions:

- Stop using this Product if you notice any discomfort.



Setting Up a Safe Environment:

- This Product is intended for indoor use only. It produces an immersive virtual reality experience designed to be as realistic as possible, which distracts you and blocks the view of your actual surroundings.
- Always be aware of your physical surroundings before using this Product. Ensure that you have sufficient open space for moving your weapon controller in GAIM scenarios.
- Be aware that viewing your use of this Product could cause alarm to outside observers.
- Safety grids are provided within the Product's virtual environment. Do not violate or exceed the area outside of these safety grids while using the Product as the weapon controller could hit physical objects or people.

Battery Instructions and Warnings:

- Use only new CR-2032 lithium batteries with this Product.
- Do not mix used batteries or other battery types or install batteries backwards.
- Do not place batteries in a pocket, purse, or other container containing metal objects, or store along with hazardous or combustible materials.
- Do not expose products containing batteries to excessive heat (e.g. direct sunlight, fire, etc.).
- Always store batteries in a cool, dry, and ventilated area.
- Follow all local laws regarding safe disposal of used batteries.

Regulatory Information

GAIM VR QH1 operates using Bluetooth® in the 2.4GHz license-free frequency band.
 Max radiated output power (EIRP): +5dBm

Europe

This product is intended for indoor use only.
 This product complies with the applicable CE marking directives and harmonized standards.

- Radio Equipment Directive (RED) 2014/53/EU
- Restrictions of Hazardous Substances (RoHS) Directive 2011/65/EU

A copy of the original declaration of conformity may be obtained from GAIM Immersive Technology Group AB at www.gaim.com.

Electromagnetic compatibility (EMC)

This equipment has been designed and tested to fulfil applicable standards for:

- Radio frequency emission when installed according to the instructions and used in its intended environment.
- Immunity to electrical and electromagnetic phenomena when installed according to the instructions and used in its intended environment.

Disclaimer

GAIM assumes no responsibility or liability for any errors or omissions in the content of this document, nor any of its web sites. The information contained in this document is provided on an "as is" basis with no guarantee of completeness, accuracy, usefulness or timeliness and may be subject to alterations without notice.

Regulatory Information

USA

Contains FCC ID: XPYANNAB1

This device complies with part 15 of the FCC Rules. Operation is subject to the following two conditions:

- (1) This device may not cause harmful interference, and,
- (2) this device must accept any interference received, including interference that may cause undesired operation. This equipment has been tested and found to comply with the limits for a **Class B digital device, pursuant to Part 15 of the FCC Rules**. These limits are designed to provide reasonable protection against harmful interference in a residential installation. This equipment generates, uses and can radiate radio frequency energy and, if not installed and used in accordance with the instructions, may cause harmful interference to radio communications. However, there is no guarantee that the interference will not occur in a particular installation. If this equipment does cause harmful interference to radio or television reception, which can be determined by turning the equipment off and on, the user is encouraged to try to correct the interference by one or more of the following measures:

- Reorient or relocate the receiving antenna
- Increase the separation between the equipment and receiver
- Connect the equipment into an outlet on a circuit different from that to which the receiver is connected.
- Consult the dealer or an experienced radio/TV technician for help.

Caution Any changes or modifications NOT explicitly APPROVED by GAIM Immersive Technology Group AB may void the user's authority to operate the equipment.

Regulatory Information

Canada

Contains IC: 8595A-ANNAB1

This device complies with Industry Canada license-exempt RSS standard(s). Operation is subject to the following two conditions:

- (1) This device may not cause interference; and,
- (2) this device must accept any interference, including interference that may cause undesired operation of the device

RF Exposure information

IC compliance

This equipment complies with the requirements of **IC RSS-102 issue 5 radiation exposure limits** set forth for an uncontrolled environment. Having a separation distance of minimum 10mm between the user and/or bystander and the antenna/or radiating element ensures that the output power (e.i.r.p) of GAIM VR QH1 is below the SAR evaluation exemption limits defined in RSS-102 issue 5.

FCC compliance

This device complies with the radiation exposure limits set forth for an uncontrolled environment. The maximum output power of GAIM VR QH1 is below the SAR test exclusion limits presented in KDB 447498 D01v06 applicable for separation distances between 0 and 5 mm. Therefore, SAR evaluation is not needed.

Disposal and recycling

When this product has reached the end of its useful life, dispose of it according to local laws and regulations. For information about your nearest designated collection point, contact your local authority responsible for waste disposal. In accordance with local legislation, penalties may be applicable for incorrect disposal of this waste.

Europe

 This symbol means that the product shall not be disposed of together with household or commercial waste. Directive 2012/19/EU on waste electrical and electronic equipment (WEEE) is applicable in the European Union member states. To prevent potential harm to human health and the environment, the product must be disposed of in an approved and environmentally safe recycling process. For information about your nearest designated collection point, contact your local authority responsible for waste disposal. Businesses should contact the product supplier for information about how to dispose of this product correctly. This product complies with the requirements of Directive 2011/65/EU on the restriction of the use of certain hazardous substances in electrical and electronic equipment (RoHS).

Label information

The product label can be found on the back side of the trigger unit. To access the label, remove trigger unit from wooden stock by unscrewing the two screws holding the trigger unit in place.

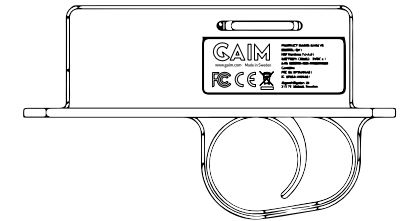

Contact information is available on www.gaim.com

Warranty

This Warranty covers defects and malfunctions in the GAIM product(s) it accompanies and does not affect the mandatory consumer protection and/or product liability legislation. We warrant that the GAIM product will, under normal and intended use, function substantially in accordance with our technical specifications or accompanying product documentation (the "Warranted Functionality") during the Warranty Period.

If and to the extent the GAIM product needs GAIM software or services to achieve the Warranted Functionality, we will make and keep software and services available during the Warranty Period. We may update, modify or limit such software and services in our sole discretion so long as we continue to maintain (or exceed) the Warranted Functionality. Product registration is not required as a condition to coverage under this Warranty, but GAIM products require periodic connection to an online GAIM account to ensure full functionality.

This limited Warranty continues for one (1) year from the date of purchase or delivery of the GAIM product, whichever is later (the "Warranty Period"). However, if you purchase the Product from within the EU or EFTA, the Warranty Period shall be two (2) years.

To claim defect or malfunction, send a photo or video and weapon controller with written description of the problem to the contact as described on www.gaim.com/support

Warranty does not cover accidents while using the product, improper care, non-intended use or lack of service/maintenance of the product.

GAIM

Ready for reality

Support



www.gaim.com/support



Copyright © GAIM 2023